

# WEARTOUGH<sup>®</sup> SERIES MODEL FL-100 DOCK SEAL

# NORDOCK<sup>®</sup>

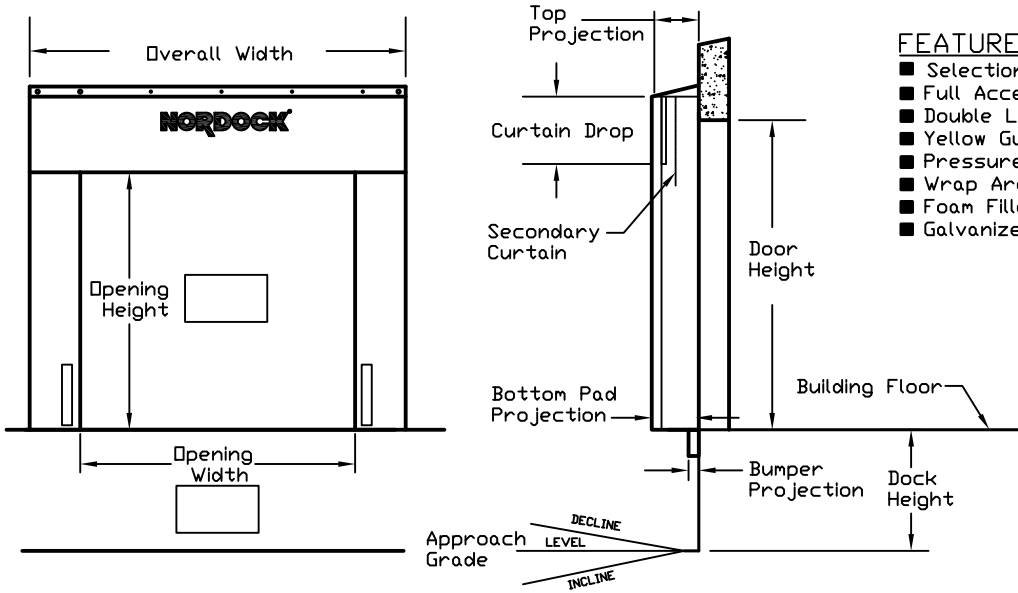

### FEATURE SUMMARY

- Selection of High Tear Abrasion Resistant Fabrics
- Full Access Design With Foam Filled Head Curtain
- Double Lock Stitched With High Strength Thread
- Yellow Guide Stripes for Driver Positioning
- Pressure Treated Superior Grade Backing Lumber
- Wrap Around Design with Release Holes
- Foam Filled Bottom Draft Pads
- Galvanized Steel Mounting Hardware

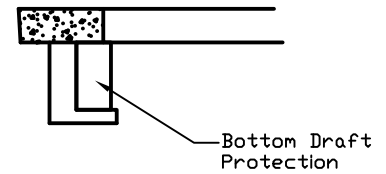

### SITE DIMENSIONS

DOOR WIDTH: \_\_\_\_\_ "

DOOR HEIGHT: \_\_\_\_\_ "

DOCK HEIGHT: \_\_\_\_\_ "

BUMPER PROJECTION: \_\_\_\_\_ "

APPROACH GRADE: \_\_\_\_\_ % SLOPE

INCLINE  DECLINE  LEVEL

GRADE WALL EXTENSION: \_\_\_\_\_ "

BUILDING WALL SETBACK: \_\_\_\_\_ "

### ORDER INFORMATION

BILL TO: \_\_\_\_\_

SHIP TO: \_\_\_\_\_

ORDER DATE: \_\_\_\_\_ QUANTITY \_\_\_\_\_

COST EACH: \_\_\_\_\_ TOTAL COST \_\_\_\_\_

PURCHASE ORDER NO. \_\_\_\_\_

NOTES: \_\_\_\_\_

### SEAL SPECIFICATIONS/OPTIONS

BASE FABRIC: 22OZ. VINYL  40 OZ. VINYL   
50 OZ. WT-90

COLOR: BLACK  BLUE VINYL  BROWN VINYL

WEAR PLEATS: 22 OZ. VINYL  40 OZ. VINYL   
50 OZ. WT-90   
EXPOSURE 4"  6"  8"

SIDE PAD: HEIGHT: 126"  OTHER \_\_\_\_\_ "

FRONT FACE: 24"  OTHER \_\_\_\_\_ "

PROJECTION: 20"  25"  30"   
OTHER: \_\_\_\_\_ "

TERMINATOR<sup>TM</sup> GAP SEAL

HEAD CURTAIN: WIDTH: 139"  OTHER \_\_\_\_\_ "

DROP: 24"  OTHER \_\_\_\_\_ "

OPTIONS:  
SECONDARY CURTAIN  \_\_\_\_\_ "

ADJUSTABLE SECONDARY CURTAIN

OTHER: \_\_\_\_\_

\_\_\_\_\_

\_\_\_\_\_

\_\_\_\_\_